





LEGENDA

-  PERIMETRO COMPARTO
-  RETI ELETTRICHE ESISTENTI
-  ROBINIA
-  SALICE BIANCO
-  PIOPPA NERO
-  LECCIO
-  PIOPPA BIANCO
-  CANNETO
-  ROVI
-  VIABILITA' ATTUALE
-  CANALE SCOLMATORE

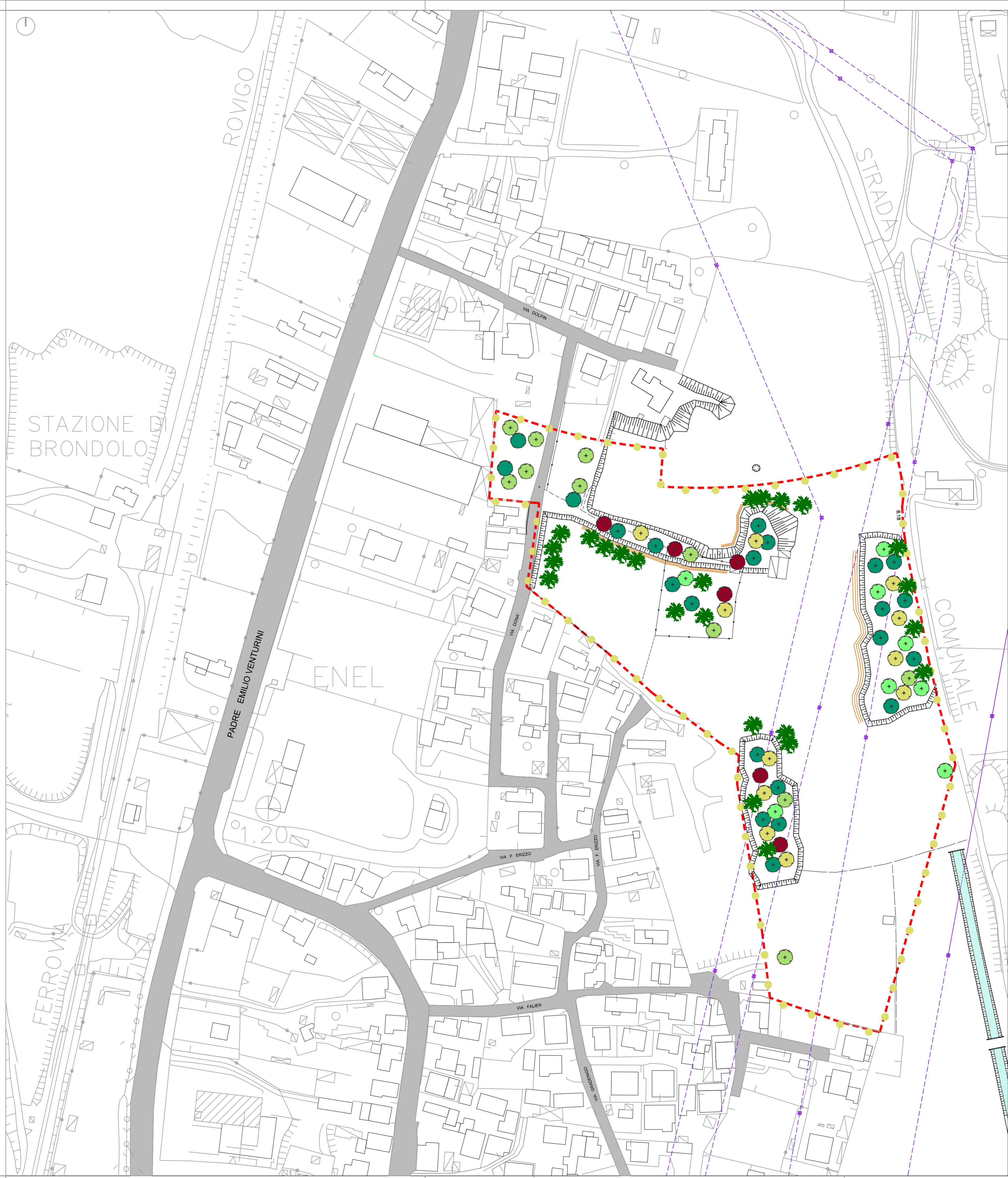

PIANO URBANISTICO ATTUATIVO
Z.T.O. C2 - A.I.U. 20 Località BRONDOLO EST
 Stato di fatto con individuate:perimetro d'intervento,
 essenze arboree e infrastrutture esistenti

PROGETTO

OGGETTO

COMMITTENTE **Consorzio C/2-20**

1:1000	scala
OTTOBRE 2015	data
*	rogg.
Z:\Comparto 20\Richiesta Piano Attuativi	file
Progetto piano attuativo.dwg	

5

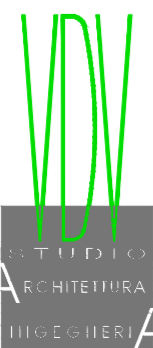

STUDIO
ARCHITETTURA
DISEGNI